



GLOBAL PROTECT (VPN) Guide for Student

Installation Guide for Windows 10 and Android Devices

Installation Guide for Windows 10.....	2
Installation Guide for Android Devices	7

Installation Guide for Windows 10.

Currently supported Version:

- Windows 10 32bit and 64bit version

You can check if your Windows OS is 32 bit or 64 bit by right click on “**My Computer**” ->**Click on Properties**. It will show under “**System**” in right pane.

1. Open your **Chrome** browser and key-in <https://sitvpn.singaporetech.edu.sg>.
2. Key-in your Username: **Student ID** and Password: **Student ID Password**.



3. Select “Download Windows 64 bit GlobalProtect agent”.



4. The file will auto download, and you can find at the bottom of your browser.

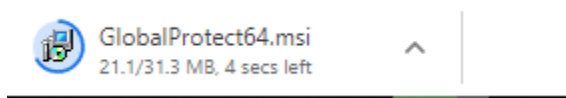

5. Click **Next**.

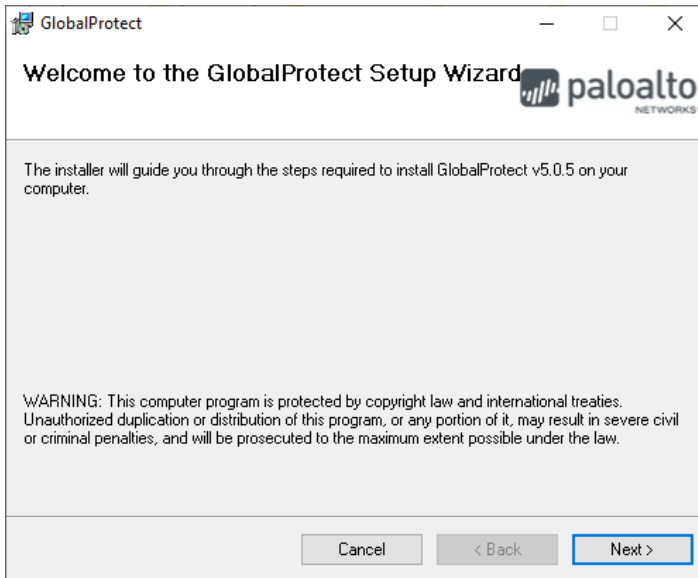

6. Click **Next**.

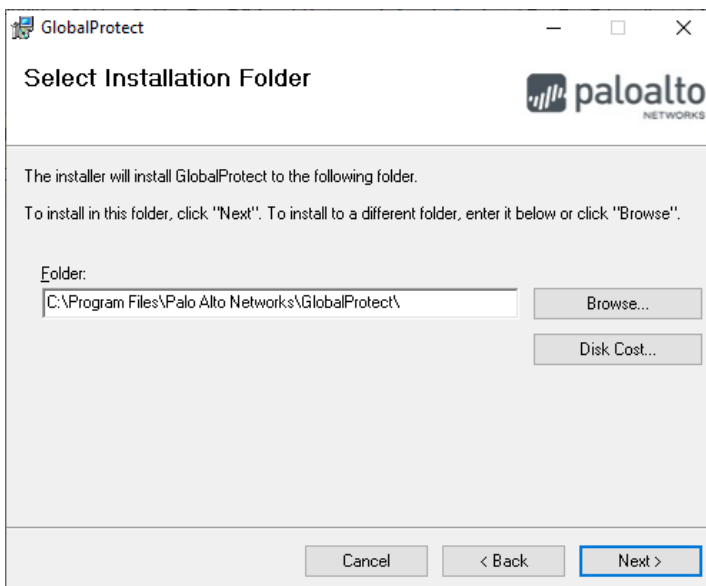

7. Click **Next**.

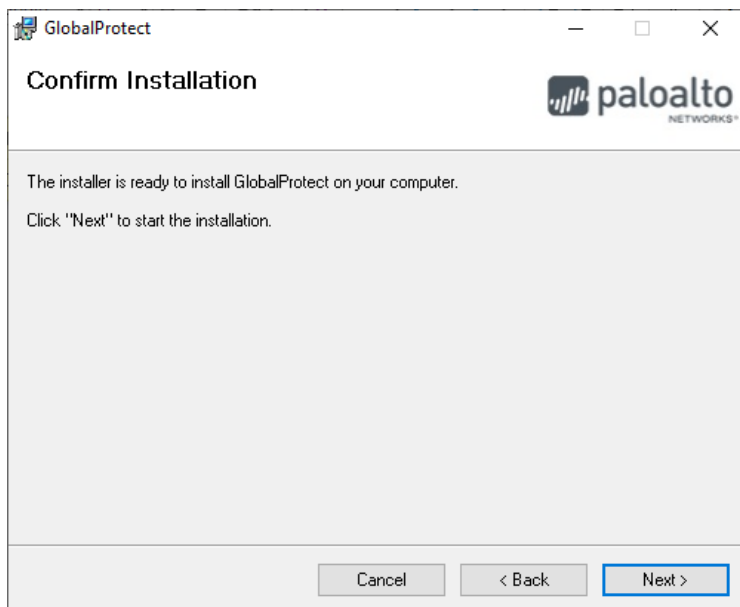

8. Click **Close** to finish the installation.

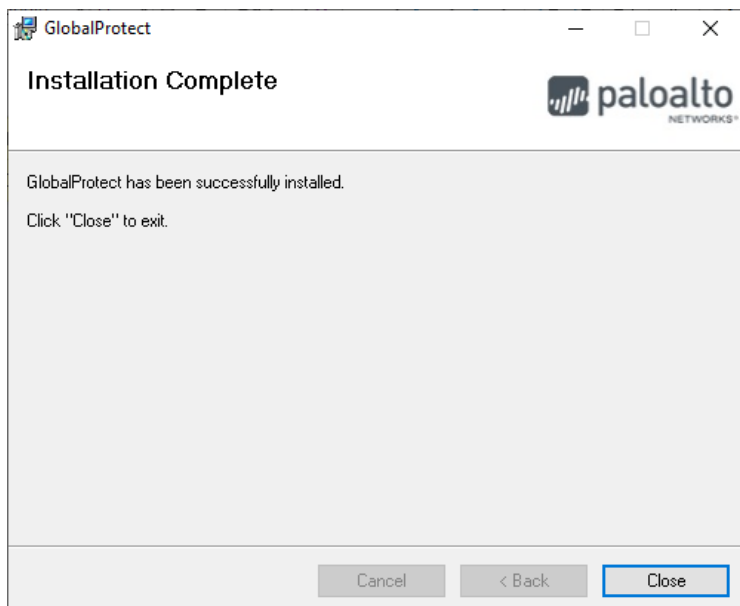

9. Click the Windows button  and select **GlobalProtect** to launch the

10. VPN. Key-in “**sitvpn.singaporetech.edu.sg**” and click “**Connect**”.

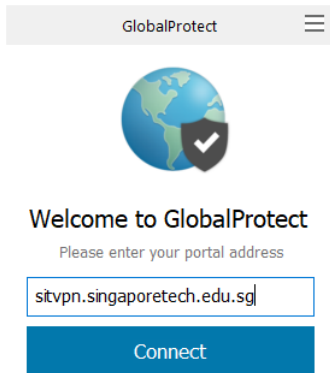

11. Sign In with your “**STUDENT ID**” and “**Password**”.

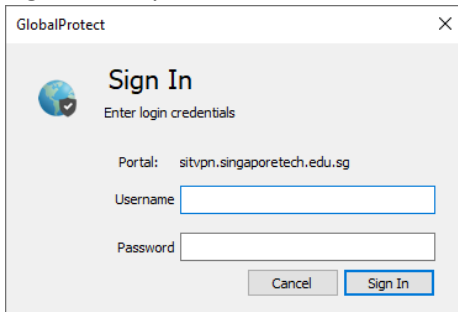

12. Click “**Connect**”.

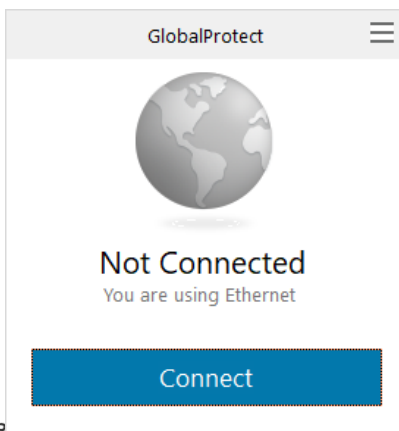

Installation Guide for Android Devices

Current Support Version: **Android 4.0.3 and Later.**

1. Open your **Play Store Apps**. Search “**GlobalProtect**”.
2. Click **Install**.

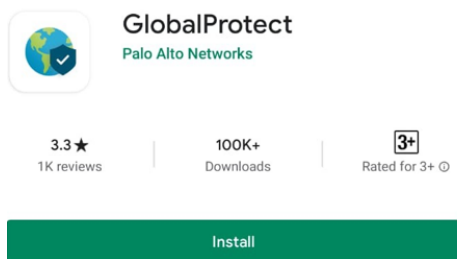

3. Key-in **sitvpn.singaporetech.edu.sg**. Click **Connect**.

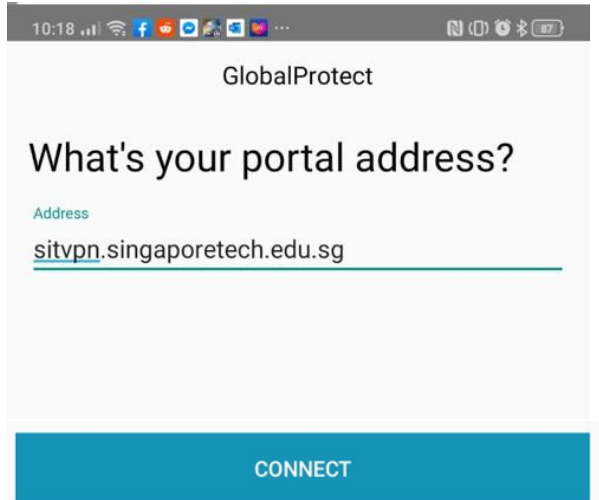

4. Sign in using the **STUDENT ID** and **PASSWORD**.

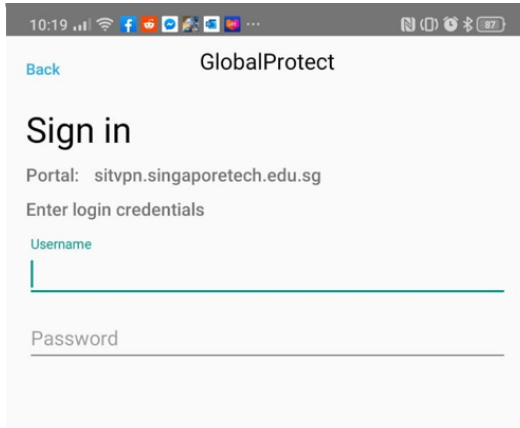

5. Click **Always Allow**.

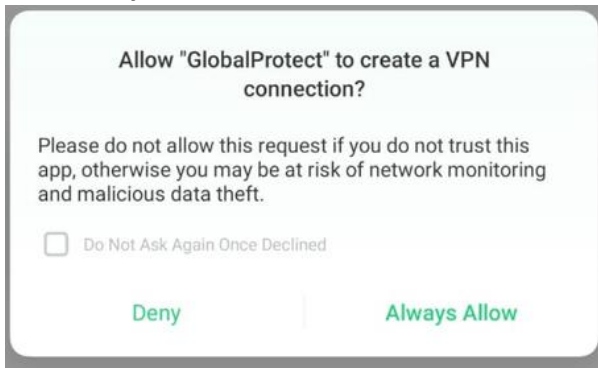

6. The GlobalProtect will show **Connected**.

